

# X-am 2800/5800

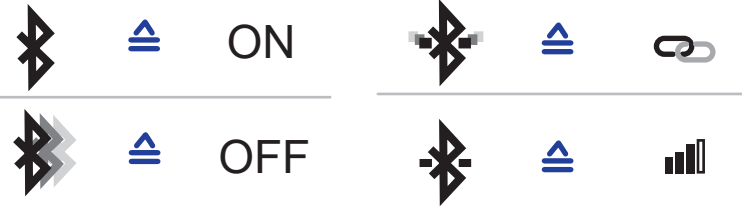



Any use of the device requires full understanding and strict observation of the Instructions for Use of the device. This Quick User Guide does not replace the Instructions for Use of the device! <https://www.draeger.com/ifu?SearchTerm=x-am+2800>

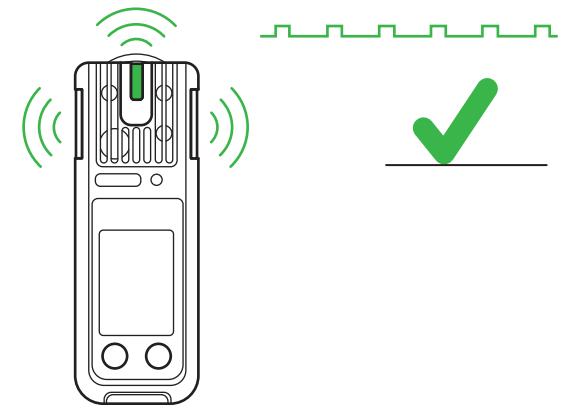
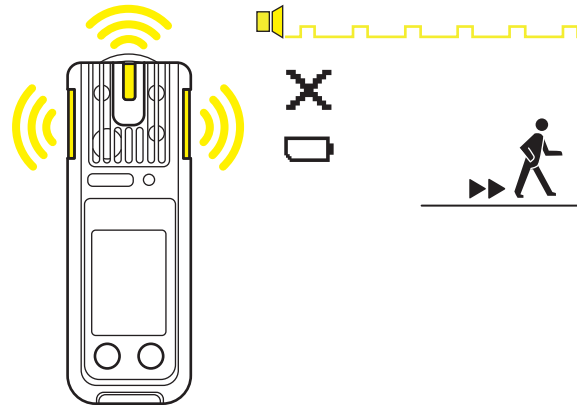
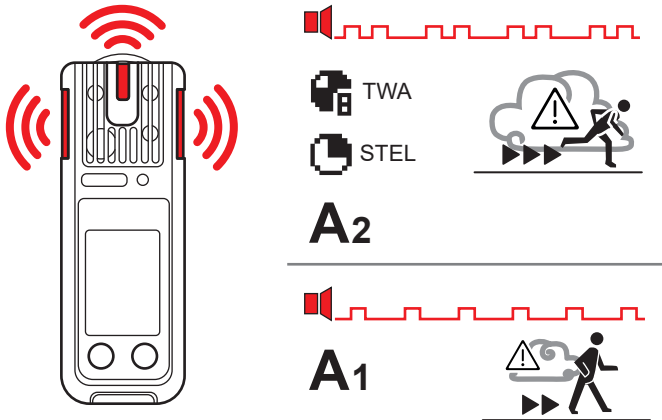
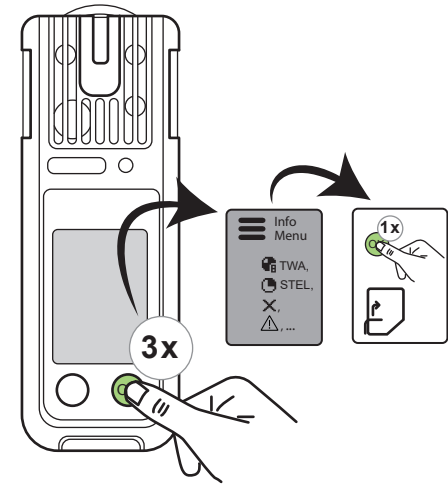
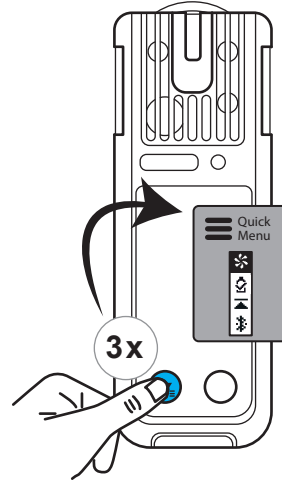
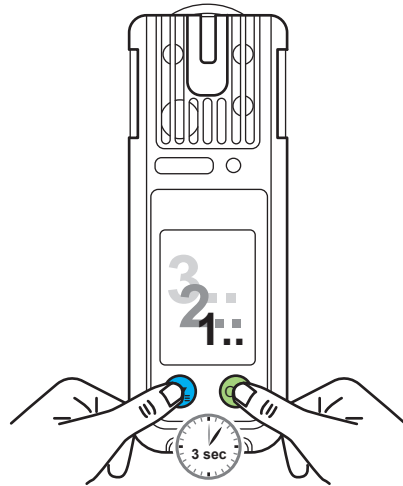
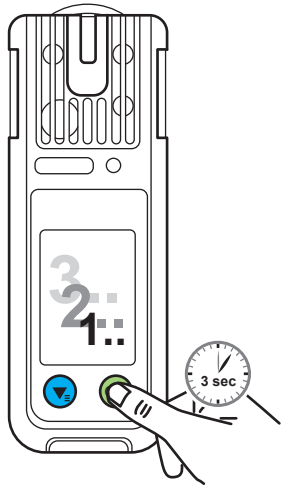

ON

OFF



 Jede Verwendung des Produkts setzt das vollständige Verständnis und die strikte Einhaltung der Gebrauchsanweisung des Produkts voraus. Diese Kurzanleitung ersetzt nicht die Gebrauchsanweisung des Produkts!  
<https://www.draeger.com/ifu?SearchTerm=x-am+2800>



 Любое использование устройства требует полного понимания и строгого соблюдения руководства по эксплуатации. Это краткая инструкция не заменяет руководство по эксплуатации изделия!  
<https://www.draeger.com/ifu?SearchTerm=x-am+2800>



 Toute utilisation du produit suppose la compréhension totale et le respect strict de la notice d'utilisation du produit. Cette notice abrégée ne remplace pas la notice d'utilisation du produit !  
<https://www.draeger.com/ifu?SearchTerm=x-am+2800>



 Öнімнің kez kelgen qoldanylyuы үшін öнімнің paidalanuы jöningeđi nұsqaulыğyn tolyqtai түsinu және büljytpai oryndau qajet. Bül qysqaşa nұsqaulыq öнімнің paidalanuы jöningeđi nұsqaulыğyn almastyрмаidy!  
<https://www.draeger.com/ifu?SearchTerm=x-am+2800>



 Cualquier uso del producto requiere la plena comprensión y el estricto cumplimiento de las instrucciones de uso del producto. Estas instrucciones breves no sustituyen a las instrucciones de uso del producto.  
<https://www.draeger.com/ifu?SearchTerm=x-am+2800>



 Ürünün her türlü kullanımında kullanım kılavuzunun tümüyle anlaşılmiş olması ve yönergelerine sıkı sıkıya bağlı kalınması zorunludur. Bu kısa kılavuz ürüne ait kullanım kılavuzunun yerine geçmez!  
<https://www.draeger.com/ifu?SearchTerm=x-am+2800>



 Qualquer uso do produto requer total compreensão e estrito cumprimento das instruções de uso do produto. Esse guia rápido não substitui as instruções de uso do produto!  
<https://www.draeger.com/ifu?SearchTerm=x-am+2800>



 製品を使用するには製品の取扱説明書を完璧に理解しており厳密に従うことが前提です。このクイックスタートガイドは製品取扱説明書に代わるものではありません！  
<https://www.draeger.com/ifu?SearchTerm=x-am+2800>



 Qualsiasi uso del prodotto presuppone la piena comprensione e la stretta osservanza delle istruzioni per l'uso del prodotto stesso. Le presenti istruzioni brevi non sostituiscono le istruzioni per l'uso del prodotto!  
<https://www.draeger.com/ifu?SearchTerm=x-am+2800>



 每次使用产品前必须完全理解使用说明，必须严格遵守使用产品。本简要说明书无法替代产品的使用说明！  
<https://www.draeger.com/ifu?SearchTerm=x-am+2800>



 Elk gebruik van het product vereist volledig begrip en strikte naleving van de gebruiksaanwijzingen van het product. Deze korte handleiding vervangt niet de gebruiksaanwijzing van het product!  
<https://www.draeger.com/ifu?SearchTerm=x-am+2800>



 제품을 사용하려면 제품의 사용 지침서를 완전히 이해하고 엄격하게 준수해야 합니다. 이 간단 지침은 제품의 사용 지침서를 대체하지 않습니다!  
<https://www.draeger.com/ifu?SearchTerm=x-am+2800>

