

Quick start guide – HI-Flow Star for adults

1a Connection to a blender

1. Connect the O₂ hose (A) of the blender-kit to the blender (B) and the water chamber (C).
2. Connect the heated inspiratory hose to the second opening of the water chamber.
3. Attach the heating cable adaptors and temperature sensors to the humidifier and hose system.

If the blender is being used with a 22 mm adaptor (available separately), the short blue inspiratory hose is used instead of the O₂ hose.

The short blue inspiratory hose is not used to connect to a blender.

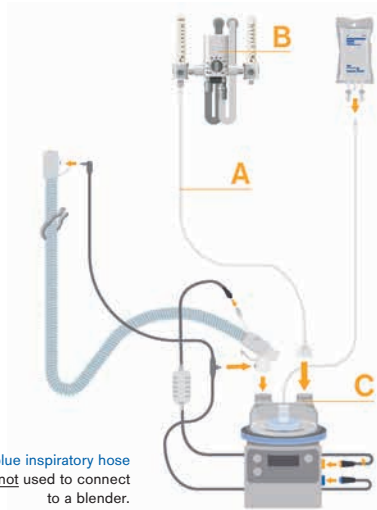

1b Connecting to a ventilator

1. Connect the short blue inspiratory hose (A) to the inspiratory port of the ventilator (B) and to the water chamber (C).
2. Connect the heated inspiratory hose to the second opening of the water chamber.
3. Connect the heating cable adaptors and temperature sensors to the humidifier and hose system.

The blender-kit is not used when connecting to a ventilator.

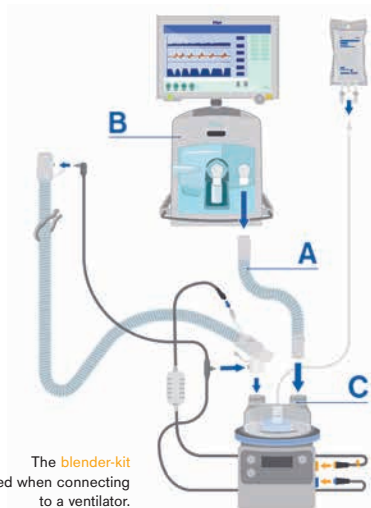

2

1. Use the sizing gauge to establish the size of the prong required. The sizing gauge shows the prong sizes available.
2. The prong should only close the nostrils to a maximum of 50%.
3. Connect the nasal cannula to the inspiratory hose.
4. Start the device as per the instructions for use and set the parameters. Check that there is a respiratory flow coming out of the prong.

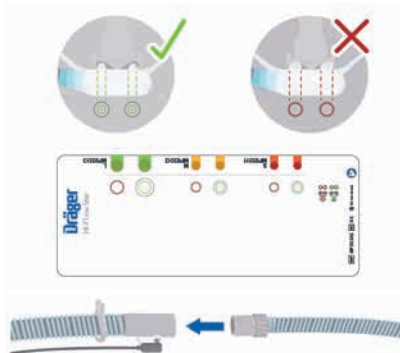

3

1. For the best possible fit, attach the bed clip to the patient's clothing or bed linen.



4

1. The nasal cannula hose may run to the left or right of the patient.
2. Turn the nasal cannula so that the hose from the nasal cannula runs in the direction of the device.
3. Carefully place the prong in the patient's nose and put the headgear on.
4. The size of the headgear can be changed by adjusting the hook and loop fasteners.

